



ROANE COUNTY SCHOOLS

813 CAPITOL STREET
SPENCER, WEST VIRGINIA 25276
(304) 927-6400
<http://roanecountyschools.com>

RICHARD D. DUNCAN, Ph.D.
SUPERINTENDENT

JEFFREY MACE
PRESIDENT, ROANE COUNTY BOARD OF EDUCATION

Ground Maintenance

The Roane County Board of Education is accepting bids for grass mowing and trimming at various school sites.

Bid forms and specifications may be obtained at the county board office or at any school. Bidders are encouraged to visit the school sites and meet with the principal to determine the areas to be mowed.

In order for bids to be considered for the 2019 season, a **Business License** and **Workers Compensation** confirmation must be submitted with the bid sheets.

Bids will be received at the Board of Education Office, 813 Capitol Street, Spencer, WV 25276 **until 2:00 p.m., Friday, March 15, 2019.** The Board reserves the right to reject any or all bids.

Bids shall be in a sealed envelope with the notation: "**BID-SCHOOL GROUND MAINTENANCE.**"

Bid Specifications for School Ground Maintenance

The Roane County Board of Education is accepting bids for grass mowing at various school sites. When more than one site is bid, each must be considered a separate bid. Mowing shall be done after normal school hours in the areas occupied by students during the day. Mowing shall be done in the attached descriptions of areas to be mowed.

Successful bidders must be over eighteen years of age and must provide all labor, equipment, and materials. The mowing equipment must be suitable for the job. In order to be considered for the 2019 season, a **Business License** and **Workers Compensation** confirmation must be submitted with the bid sheets.

The Board of Education will not assume liability for injuries or damage to equipment of the successful bidder. The bidder will be held liable for damage occurring to school property as a result of the grass mowing activities.

Successful bidders will submit properly-documented invoices for payment to the county finance office.

Bid forms and specifications may be obtained at the county office or at any school. Bidders are encouraged to visit the school sites and meet with the principal to determine the areas to be mowed.

Bids shall be in a sealed envelope with the notation **"BID-SCHOOL GROUNDS MAINTENANCE."**

Bids will be received until 2:00 PM, Friday, March 15, 2019.

BID SHEET – MOWING for ROANE COUNTY BOARD OF EDUCATION

I, the undersigned, wish to submit the following bid(s) on the area(s) specified according to the Bid Specifications for the School Grounds Maintenance.

A = Area is to be mowed approximately once per week except every other week during the summer months. Spencer Middle School and the old Board of Education Office are to be mowed approximately one per week during the summer except when specified otherwise (dry weather, etc.)

B = Area is to be mowed five times during the year.

SCHOOL	COST EACH TIME MOWED	TIMES MOWED	ESTIMATE TOTAL COST	TOTAL (A, B, & C)
GEARY ELEM/MIDDLE	A _____	22	\$ _____	\$ _____
	B _____	5	\$ _____	
SPENCER ELEM	A _____	22	\$ _____	\$ _____
	B _____	5	\$ _____	
SPENCER MIDDLE/OLD BOARD OFFICE	A _____	22	\$ _____	\$ _____
	B _____	5	\$ _____	
	C _____	1	\$ _____	
ROANE COUNTY HIGH (Part A)	A _____	22	\$ _____	\$ _____
ROANE COUNTY HIGH (Part B)	A _____	22	\$ _____	\$ _____
WALTON ELEM/MIDDLE	A _____	22	\$ _____	\$ _____
	B _____	5	\$ _____	
BUS GARAGE	A _____	22	\$ _____	\$ _____
	B _____	5	\$ _____	
MADISON AVENUE	A _____	22	\$ _____	\$ _____
	B _____	5	\$ _____	

Name of Bidder _____ Date _____

Address _____ Phone _____

Social Security Number or FEIN _____

Equipment _____

Signature of Bidder _____

Geary Elementary/ Middle School

Schedule "A"

1. All level area in front of and on each side of school extending from Gray Property Line to Knight Property Line.
2. Area directly behind school to extend to and around outdoor platform, and pathway to library/health clinic building.

Schedule "B"

1. Area from the highway to playground. This area extends the length of the lower play area, in front of building, and upper play area.
2. Area behind school building to library/health clinic building.
3. Area around fuel station, to include the banks in front of station.

Annette Claypool, Principal

Phone (304) 565-3721

Note: The areas designated Schedule "A" above are to be mowed every week when school is in session. The mowing shall be done less frequently in an exceptionally dry period. The contractor shall contract the principal to arrange times for mowing.

Gearry Elementary/Middle School

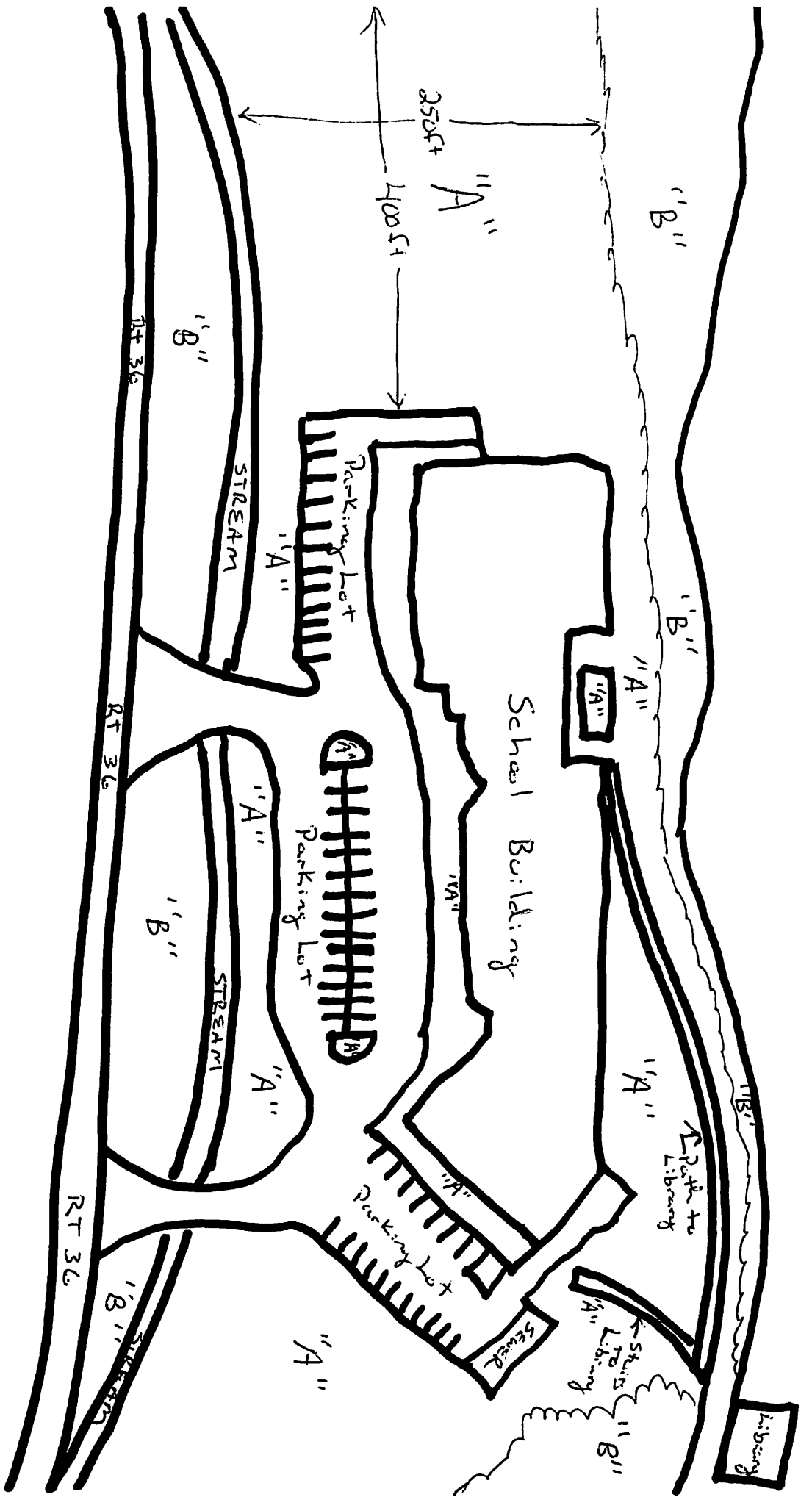

Spencer Elementary School

Schedule "A"

1. In front of building to include area between parking lots.
2. All areas on both sides of the building, extending to the bank to the east, to the tall grassy area to the west and the playground area.
3. The area behind the facility to the crest of the bank.
4. Trimming around shrubbery, parking lots, and along driveway to the school sign.

Schedule "B"

1. Areas along roadway both sides from parking lot down to the ball field including the hillside in front of parking lot down to the ball field. Above the road to the field.

Kim Frum, Principal

Phone (304) 927-6428

Note: The areas designated Schedule "A" above are to be mowed every week when school is in session. The mowing shall be done less frequently in an exceptionally dry period. The contractor shall contract the principal to arrange times for mowing.

Spencer Elementary

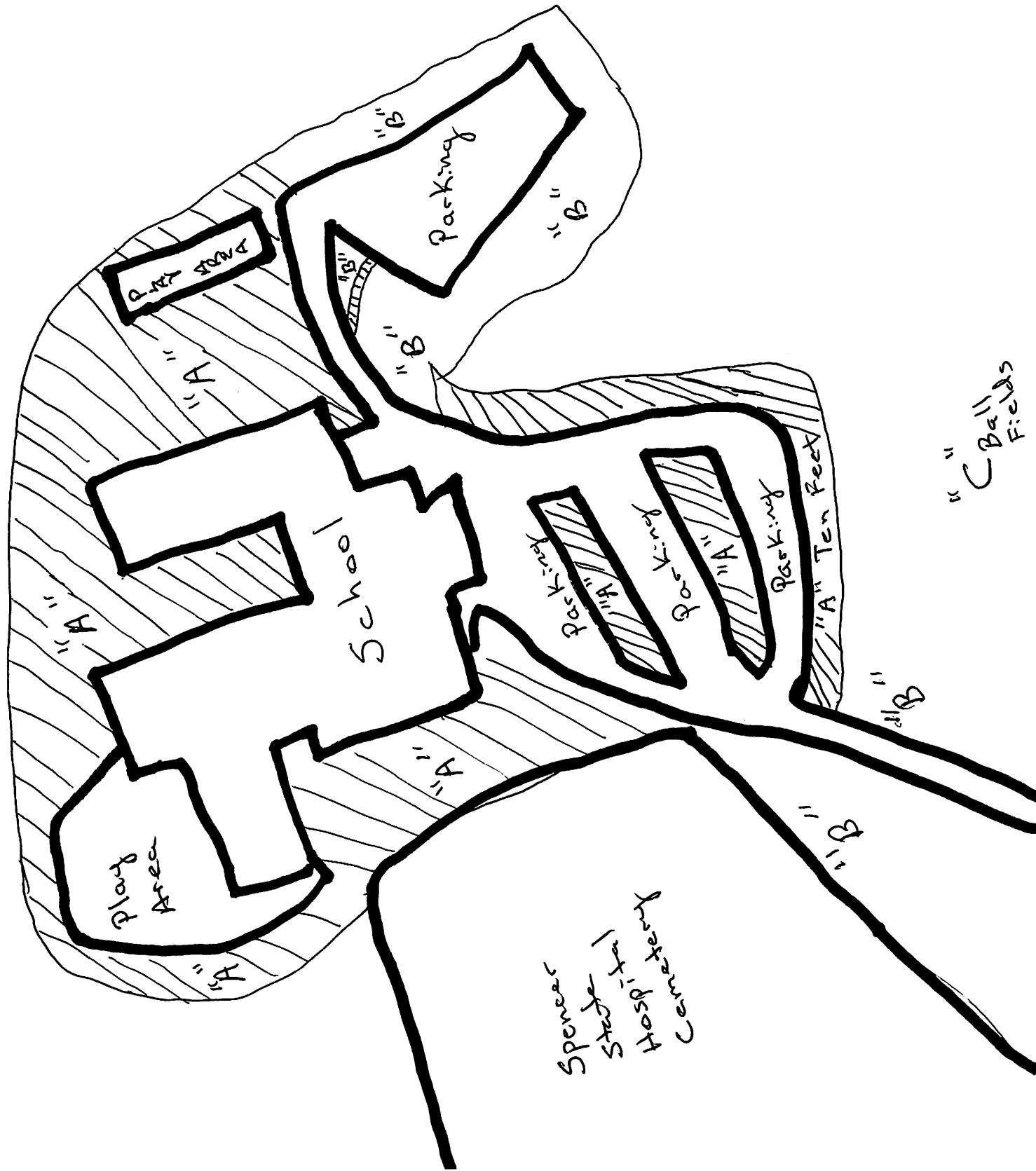

Spencer
Softball
Field
Cemented

"C" Ball Fields

Spencer Middle School and the Old Board Office

Schedule "A"

1. All the area enclosed by the chain link fence, including the football field and the baseball field. Trim around the fence, and mow the strip between the baseball field and Bowman Street.
2. All the grass area around the school. Trim along walks and scrubs.
3. All areas around Board Office Complex Trim sidewalks and scrubs.(See Jerry Garner)

Schedule "B"

1. The area along Tanner Run behind the Press Box, outside the fence.
2. The bank between the auditorium and Bowman Street.
3. The parking lot area on Bowman Street to the bridge crossing Spring Creek.
4. The banks of either side of the bleachers and keep weeds from growing from the bleachers.

Schedule "C"

1. The stream bank running between Spring Creek and the Bowman Street parking lot from Southern States to the bridge running across Spring Creek. This mowing must be completed during the month of September.

Jackie Durst, Principal

Phone (304) 927-6415

Note: The areas designated Schedule "A" above are to be mowed every week when school is in session. The mowing shall be done less frequently in an exceptionally dry period. The contractor shall contract the principal to arrange times for mowing.

Spencer Middle / OIO BOE

Baseball

Football

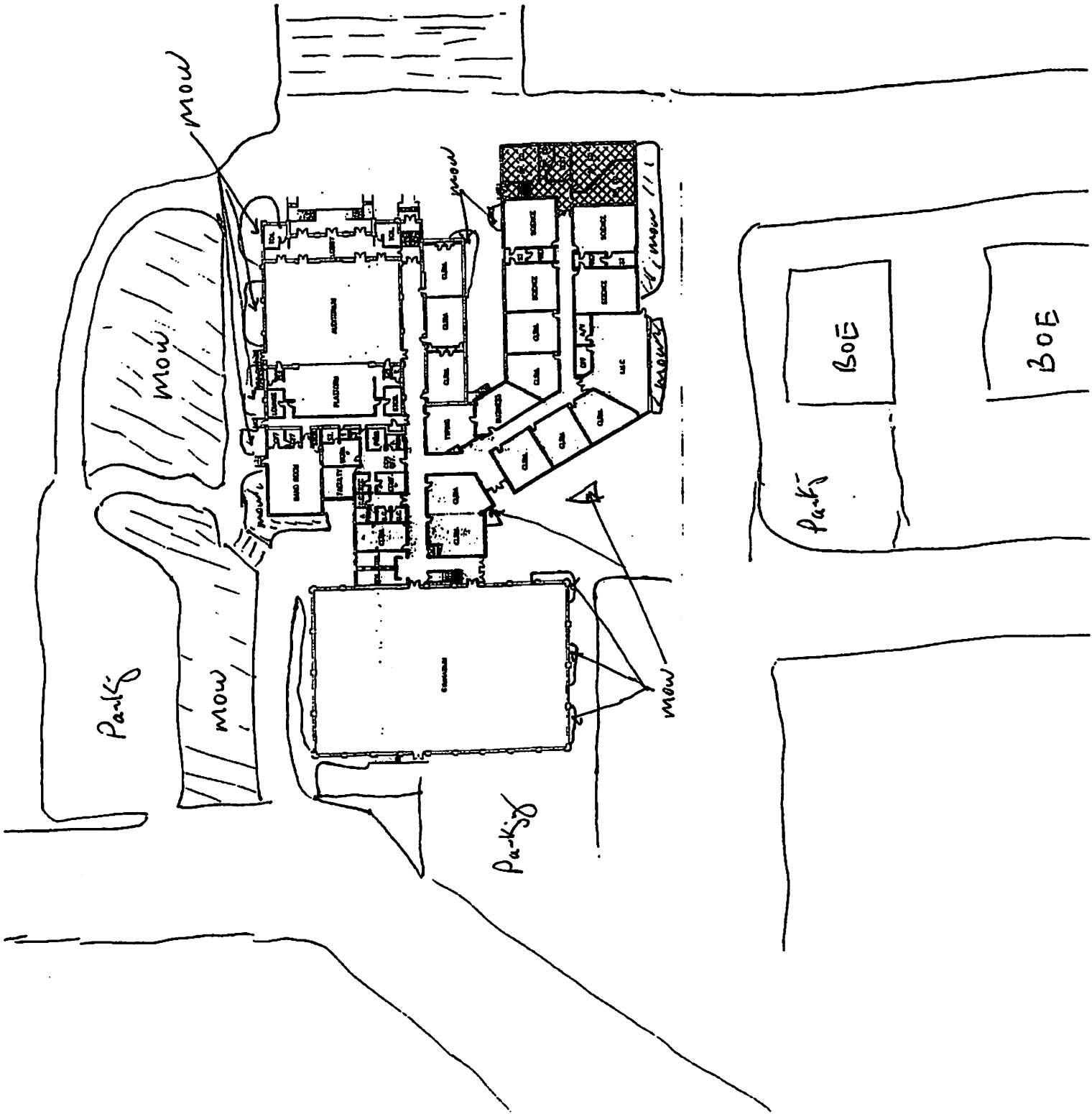

Walton Elementary/Middle School

Schedule “A”

1. Front of building to parking area.
2. Road to creek. Property line on west to creek.
3. All around new section of school, including the bus parking lot to creek.
4. From play area to creek, behind building.
5. Football field area.
6. The area from the end of the building to the pines and from parking area to and around the Walton Medical Clinic.
7. Below the Walton Medical Clinic to the creek – including the area below the edge of the bank to creek.
8. The rear of the building from the sidewalk to the edge of the bank running along the waste water treatment plant.

Schedule “B”

1. Area from the parking lot in front of school to creek.
2. Area between roadway to bus lot and school.

Natalie Garner, Principal

Phone (304) 577-6731

Note: The areas designated Schedule “A” above are to be mowed every week when school is in session. The mowing shall be done less frequently in an exceptionally dry period. The contractor shall contract the principal to arrange times for mowing.

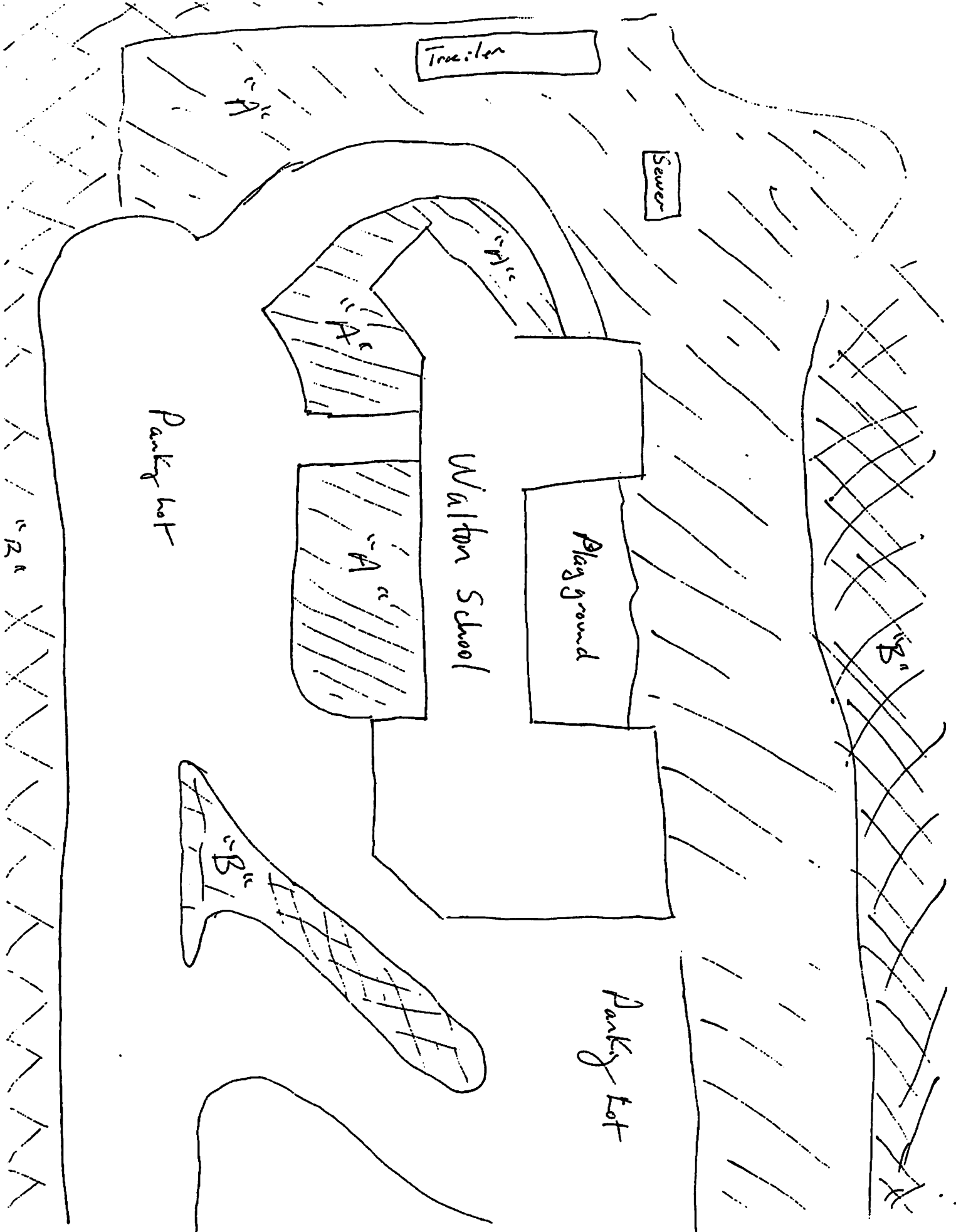

Trailer

Sewer

Playground

Walton School

Parking lot

Parking lot

"A"

"A"

"A"

"A"

"B"

"B"

"R"

Wilton Football Area

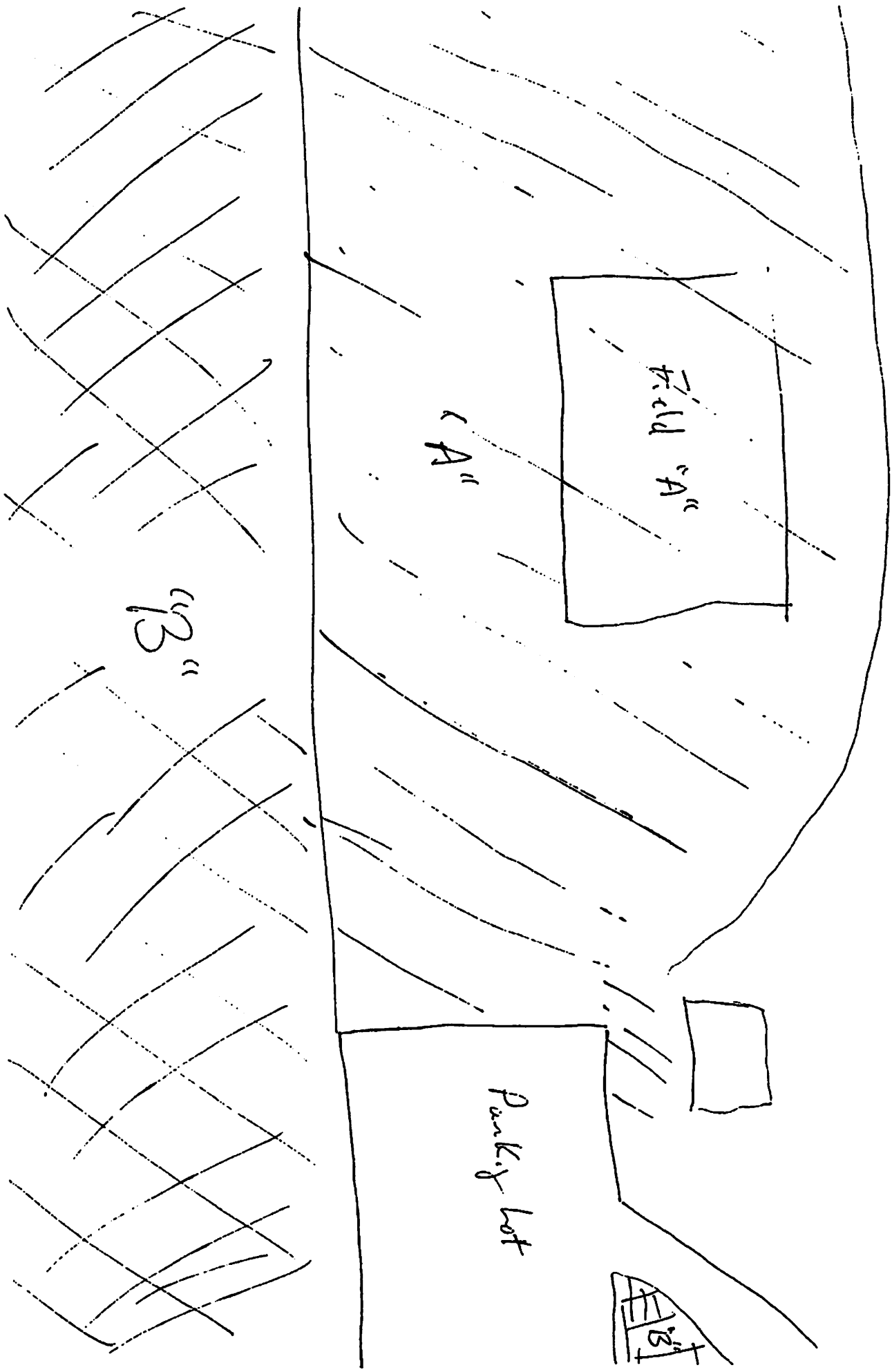

Roane County High School

Part A

Schedule "A"

Athletic Complex

1. All areas beyond the "Athletic Gate" that are outside the track, football and baseball fields.
2. The bank between the baseball field and the parking lot.
3. Ten foot path outside the baseball fence.
4. Trim around the track and baseball fences.

Roane County High School

Part B

Schedule "A"

Lick Fork Complex

1. Area between softball fence and Lick Fork Road.
2. Area around parking lot and roadway.
3. Area around the barns.
4. Boundaries of the football practice field.

Bill Heis, Principal

(304) 927-6420

Note: The areas designated Schedule "A" above are to be mowed every week when school is in session. The mowing shall be done less frequently in an exceptionally dry period. The contractor shall contract the principal to arrange times for mowing.

Spencer Bus Garage

Schedule "A"

- 1. Front area on the bus garage transportation office inside and outside the split rail fence.**
- 2. Grass area from the lower end of the bus lot to utility poles next to the Home Show property.**

Schedule "B"

- 1. Trim around driver's lounge and strip between the rocked parking lot and the edge of the bank.**
- 2. Trim around fueling station and behind the bus garage.**

Jerry Garner, Director

Phone (304) 927-6426

Note: The areas designated Schedule "A" above are to be mowed every week when school is in session. The mowing shall be done less frequently in an exceptionally dry period. The contractor shall contract the principal to arrange times for mowing.

Madison Avenue Complex

Schedule "A"

1. Area around three building, the ball field, and areas between the fence and sidewalks. Trim all sidewalks and fence.

Schedule "B"

1. Area behind the three buildings to the creek.

Jerry Garner, Director

Phone (304) 927-6432

Note: The areas designated Schedule "A" above are to be mowed every week when school is in session. The mowing shall be done less frequently in an exceptionally dry period. The contractor shall contract the principal to arrange times for mowing.